

NORTHVIEW SHOPPING CENTER A MOULTON PROPERTIES PROJECT

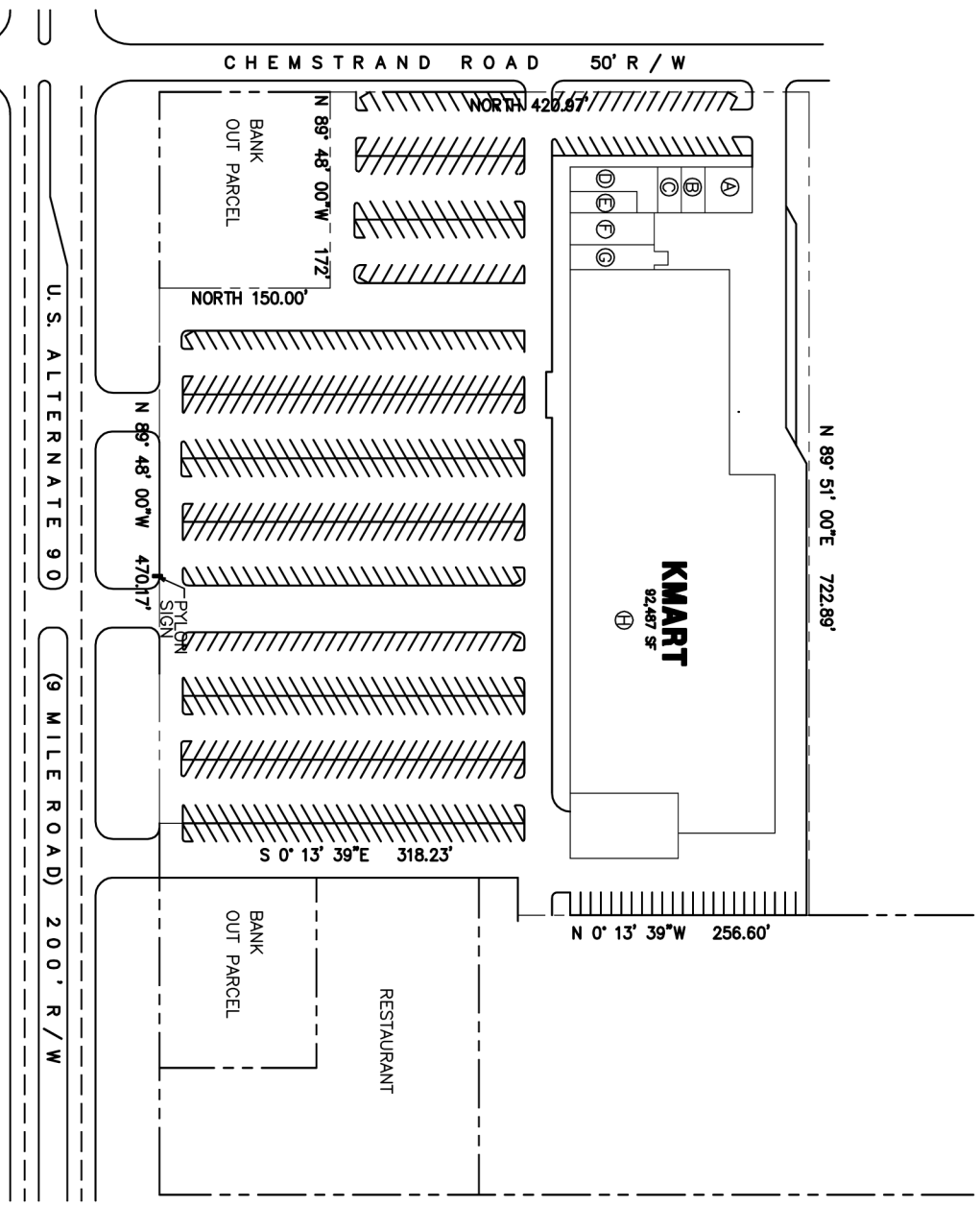

PROJECT DATA

KMART	92,487	SF
SMALL SHOPS	10,150	SF
TOTAL	102,637	SF

EXISTING TENANT KEY

- Ⓐ MARTIN HINOTE
- Ⓑ BEAUTERIA
- Ⓒ JUDY BLONK HEALTH OPTIONS
- Ⓓ Z.L. ROCHE ACCOUNTING
- Ⓔ PAPA JOHN'S
- Ⓕ AVAILABLE
- Ⓖ AVAILABLE
- Ⓗ KMART

PARKING

PARKING PROVIDED 619 SPACES
 PARKING RATING 6/1000 SF

